

Home Connect[®] Platform



- **Global BSH Brand for connected appliances**
- **Open platform**
Open to interaction with 3rd party apps and products beyond appliance's original programming
- **Works with existing WiFi routers**
No additional hardware is required
- **Secured and encrypted data**
- **Easy and intuitive Home Connect[®] app**
With full demo mode to utilize in store
- **Complete assortment of connected appliances, offering a wide variety of connected functionality**

Why Add Home Connect[®] Appliances?

#1

Added **peace of mind** with remote control, monitoring & alerts.

#2

Simplify life with smart features, external partners, or remote diagnostics.

#3

Stay on top of daily routines with **automation** like ordering dishwasher detergent or brewing a morning latte.

Master your day, in your own way.

Efficiently manage and organize household tasks, right from the convenience of your smartphone.

The Power of the App

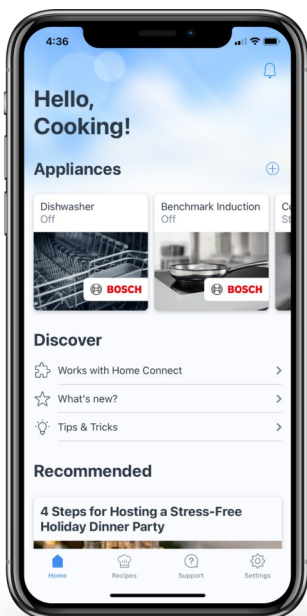

Access appliances & recommended content

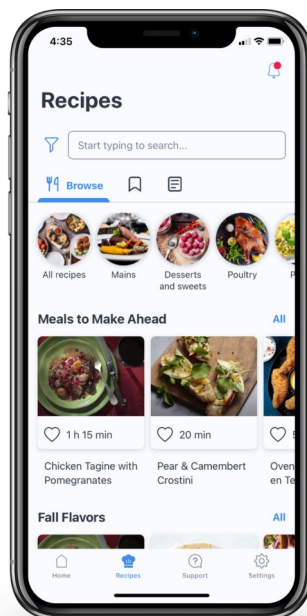

Find smart recipes & get culinary inspiration

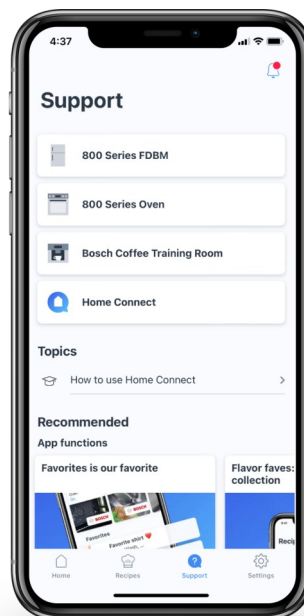

Access useful tips & recommended features

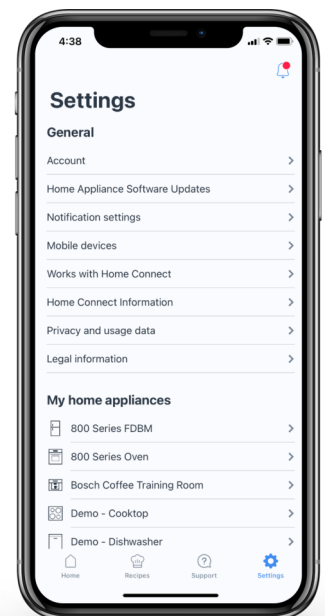

Account settings & contact information

Works With...

Simplify everyday life at home with connected technology and relevant partnerships.



Intelligent, voice activated control.

Just say “Hey Google...” for hands-free help around the house. Create smart routines and control appliances using your voice with any Google Assistant-enabled device.



Conveniently reorder products.

If the Alexa dishwasher skill is enabled, Amazon Smart Reorder can re-order your choice of dishwasher tablets each time you are getting low.



Manage your home efficiently.

With the Home Connect® app for smartwatches, receive notifications when the dishwasher cycle is complete, preheat your oven on-the-go, or brew your favorite coffee—all from your Apple Watch!

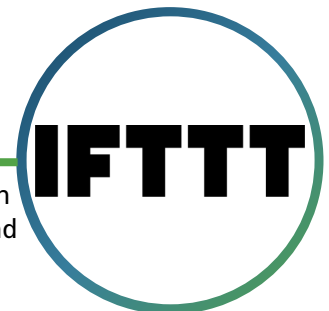

Do more with the services you love.

IFTTT Applets are new experiences you turn on with a simple switch, and they allow you to customize and better control your world. They work with Bosch appliances and hundreds of other services.



Simplifying the cooking process.

Access over 15k recipes with robust search filtering, meal planning, step-by-step guidance with photos, instructional videos, in-app timers, and smart appliance control!



Visit www.home-connect.com for a complete list of growing partners!



BOSCH

DEMO APPLIANCES

Step 1:

Download the Home Connect® app to device – search for **Home Connect (America)** or scan the appropriate QR code to the right



Step 2:

From the Home screen, press **Add Appliance**

Step 3:

Scroll to the bottom & select a generic appliance to add

SKU SPECIFIC APPLIANCES

Step 1:

Download the Home Connect® app to device – see above

Step 2:

From the Home screen, press & hold **Add Appliance** until the “Add Demo VIB” screen pops up (press & hold the + button if an appliance has already been added)

Step 3:

In the Demo VIB field, type in the desired SKU and press OK (make sure to use all capitals when entering SKU)

*Enter Dishwasher SKU: **SHP78CM5N***

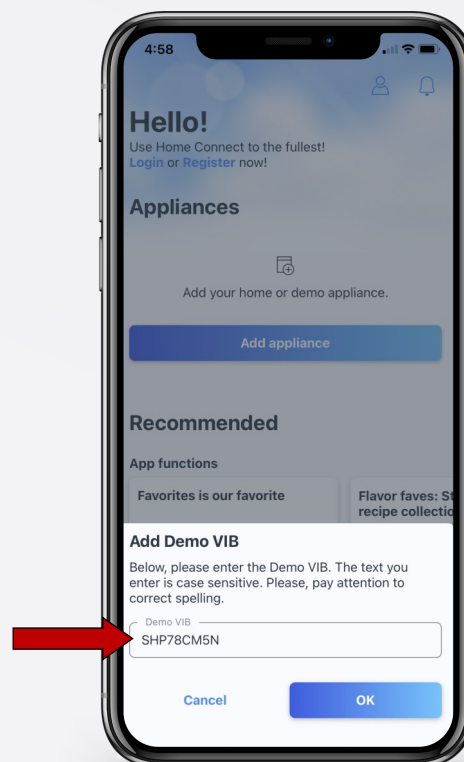
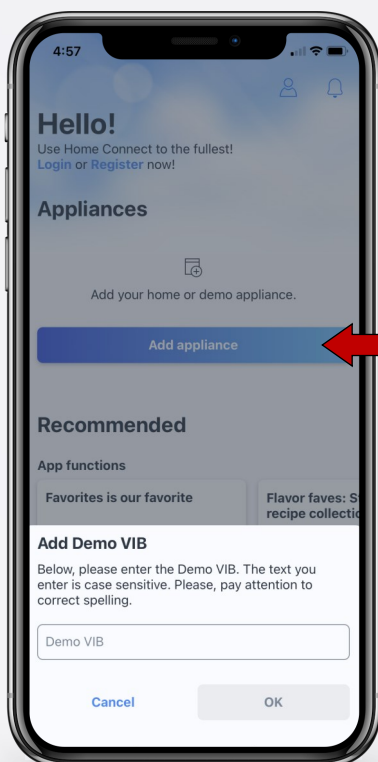

Adding specific SKUs provides the ability to showcase Home Connect® features that are unique to that series/model. By adding the Bosch 800 Series Dishwasher SHP78CM5N you can see the PowerControl™ Spray Arm customizations.